

CONTROL ENCLOSURE
CL. 1, DIV. 2, GRP. C & D.
PURGED ENCLOSURE

(SEE NOTE 3 & 4)

(BY OTHERS)
4 CONDUCTOR
SHIELDED
24V DC @ .5A

CL. 1, DIV. 1, GRP. C & D.

INSTRUMENT
VOLTAGE
115/1/60V AC @ 3A
(BY OTHERS)

ISOLATED 4-20 mA @ 24V DC
POSITION COMMAND SIGNAL
(BY OTHERS)

ISOLATED 4-20 mA @ 24V DC
POSITION OUTPUT SIGNAL
MAX $R_L = 500 \Omega$
(BY OTHERS)

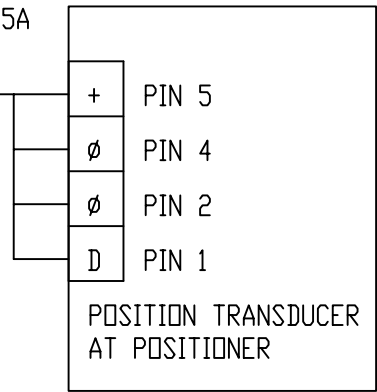
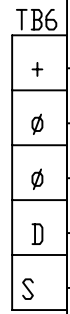
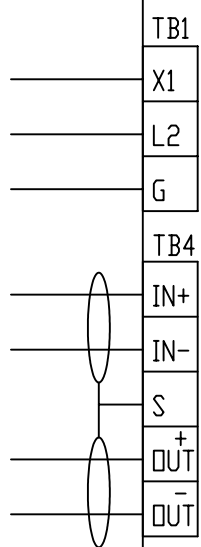

ELECTRONIC
ALARM CONTACTS
(BY OTHERS)

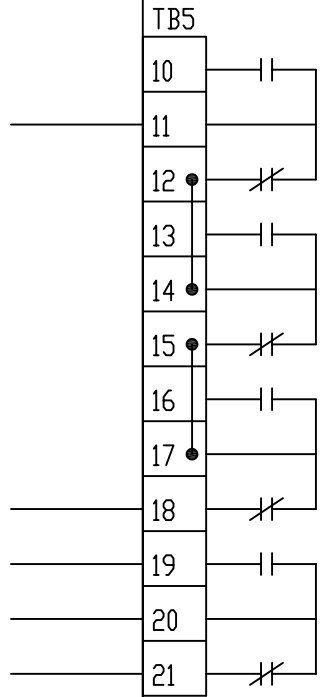

LOSS OF 4-20 mA
POSITION COMMAND
SIGNAL

LOSS OF FEEDBACK
(SIGNAL < 2mA)

LOSS OF FEEDBACK
(SIGNAL > 22mA)

LOSS OF TRACKING

NOTES:

1. ALARMS ARE SHOWN IN NORMAL OPERATING CONDITION.
2. CONTACT CLOSURE FOR START COMMAND.
3. CONTROL ENCLOSURE WIRING TYPICAL FOR 16-PV-140A, 16-UV-141, AND 16-UV-142.
4. LOCATED ON CONTROL STATION SKID.
5. LOCATED ON HPU SKID.
6. CHANGE "X" TO "A" IF VALVE IS 16-PV-140A
CHANGE "X" TO "B" IF VALVE IS 16-UV-1035
CHANGE "X" TO "C" IF VALVE IS 16-UV-1023

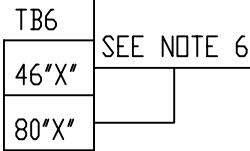

SEE NOTE 6

WIRING BY OTHERS

MOTOR CONTROL ENCLOSURE
CL. 1, DIV. 2, GRP. C & D.
PURGED ENCLOSURE

(SEE NOTE 5)

INSTRUMENT
VOLTAGE
115/1/60V AC @ 3A
(BY OTHERS)

ELECTRONIC
ALARM CONTACTS
(BY OTHERS)

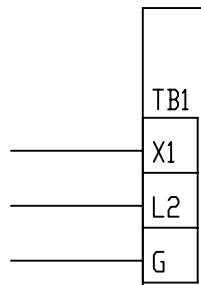

TB3

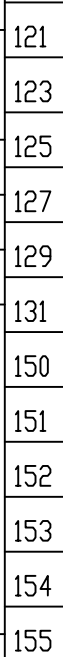

OIL LEVEL LOW

M2 START CONTACT
(SEE NOTE 2)

M1 START CONTACT
(SEE NOTE 2)

LOW OIL TEMPERATURE

HIGH OIL TEMPERATURE

SYSTEM PRESSURE LOW

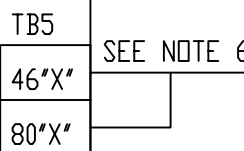

SEE NOTE 6

DATE	7-12-05	REV.	D
DRAWING NUMBER	D12417-501		
THE FIELD WIRING			
TOLERANCES	UNLESS OTHERWISE SPECIFIED		
SCALE	AS SHOWN		
APPROVED BY	[Signature]		
DESIGNED BY	[Signature]		
<p>THIS IS AN AUTOMATIC DRAWING DO NOT REVERSE MANUALLY.</p> <p>10453D</p> <p>INC., ELK GROVE, ILL.</p>			

DATE	SYM	REVISION RECORD	CON	SR	CR